

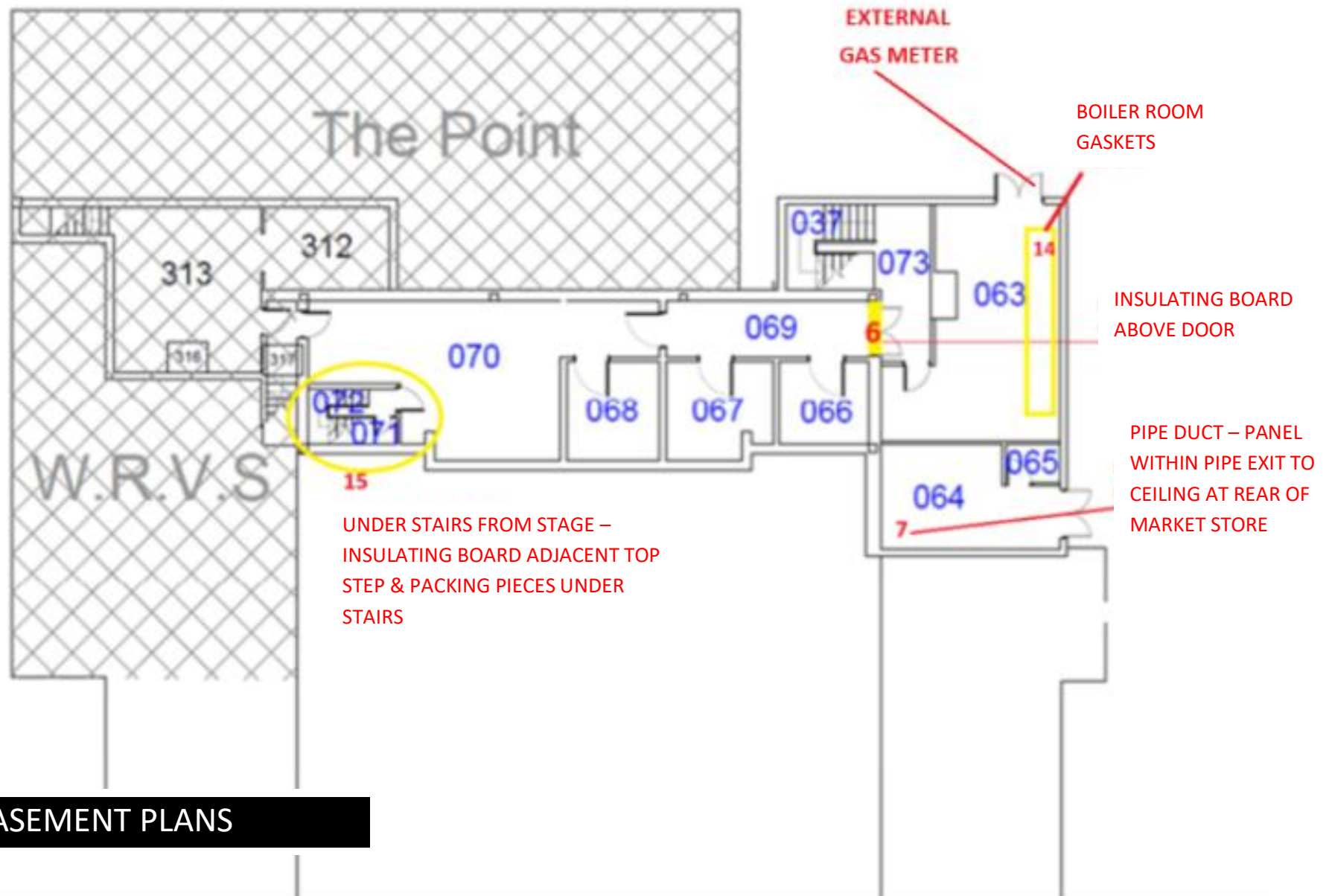

## **The Harlington Asbestos Register and Site Plans**

**Register covers locations with identified or strongly presumed  
asbestos containing materials**

*Last reviewed August 2025  
Due for review August 2026*



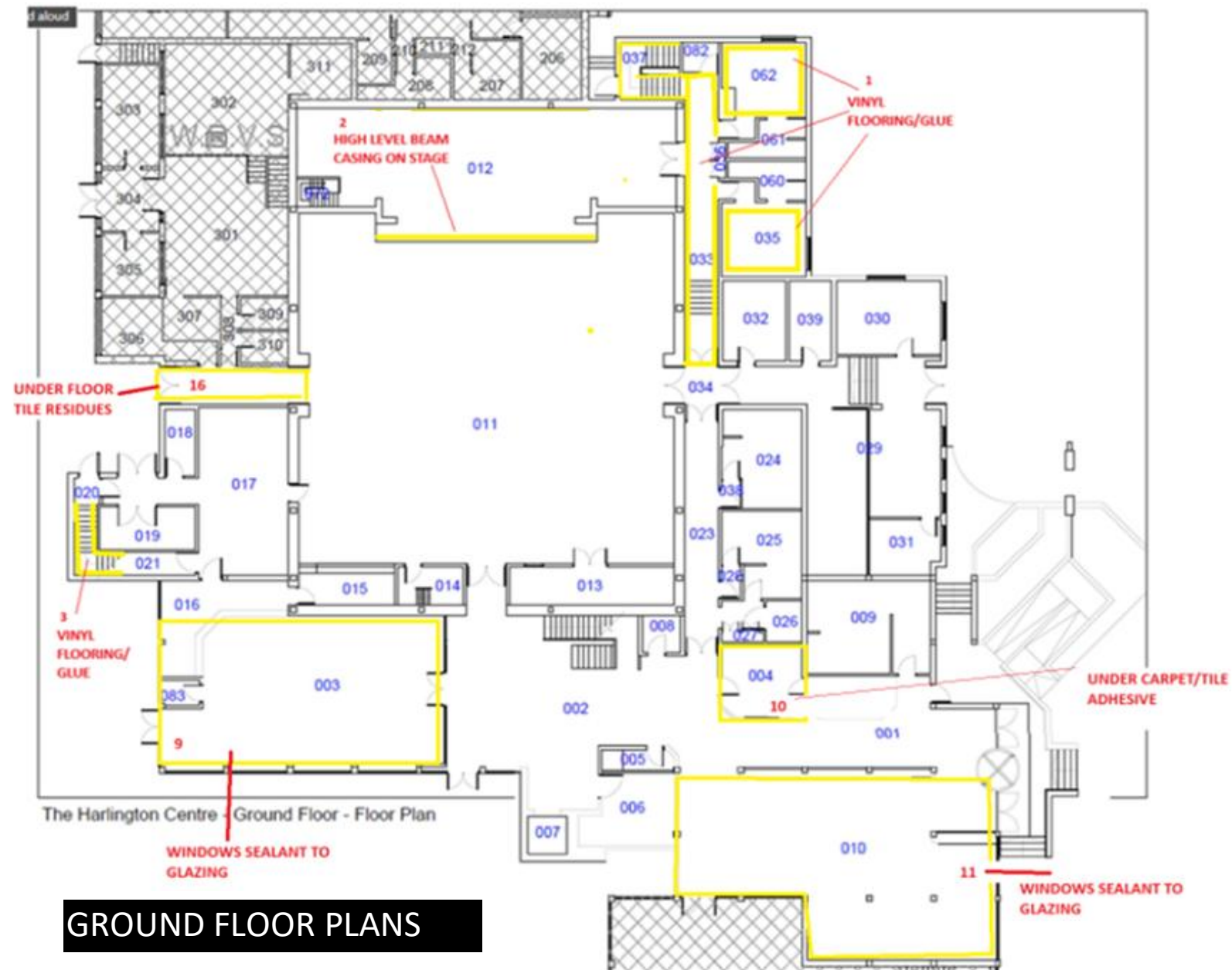

## GROUND FLOOR PLANS

17 – RVS LOFT FLOOR  
- FORMER ROOF  
COVERING

VINYL  
FLOORING/GLUE

4  
LIGHT FITTING  
SEALANT  
(VOID ABOVE GM OFFICE)

## FIRST FLOOR PLANS

12 13  
WINDOWS SEALANT TO  
GLAZING

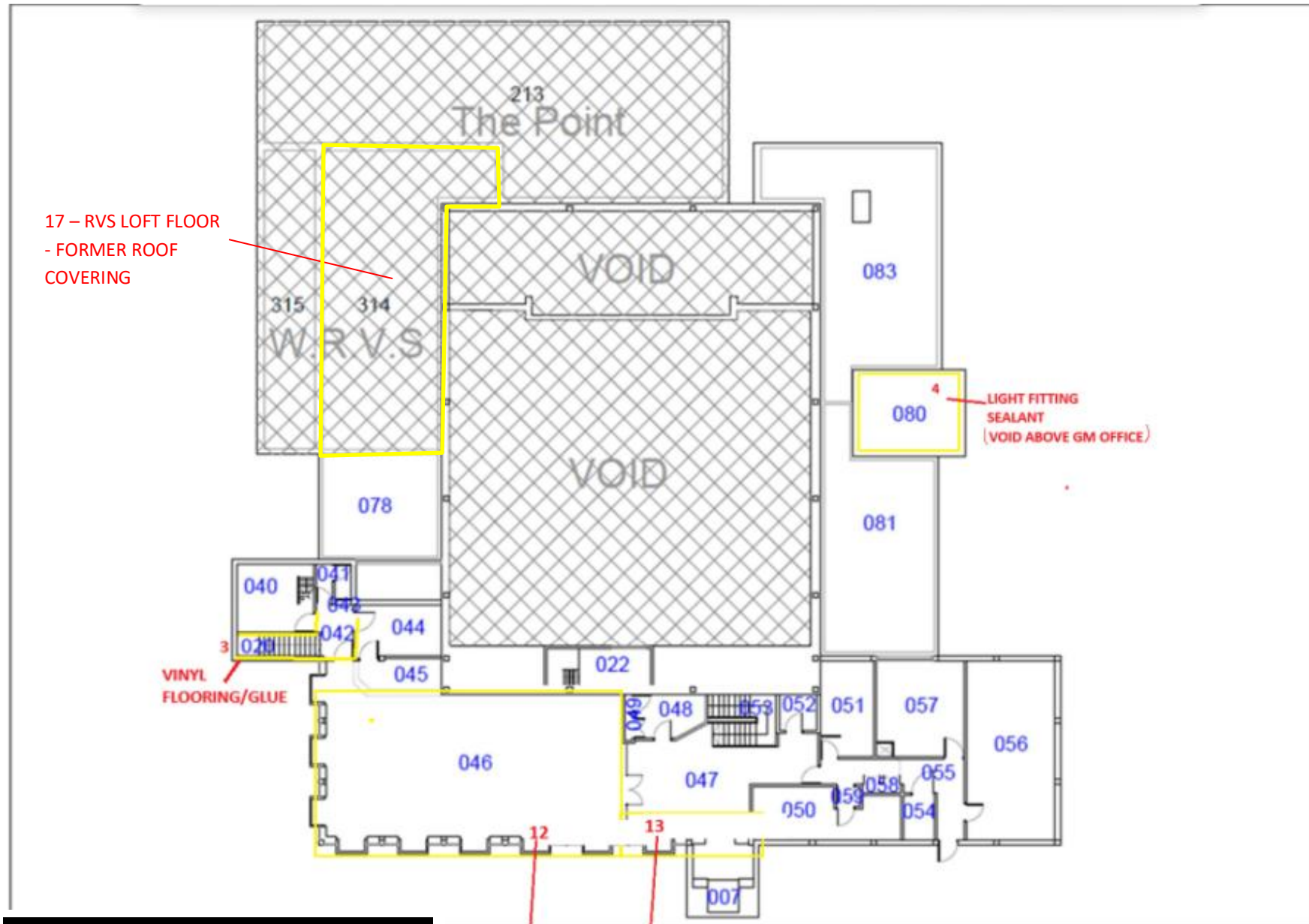



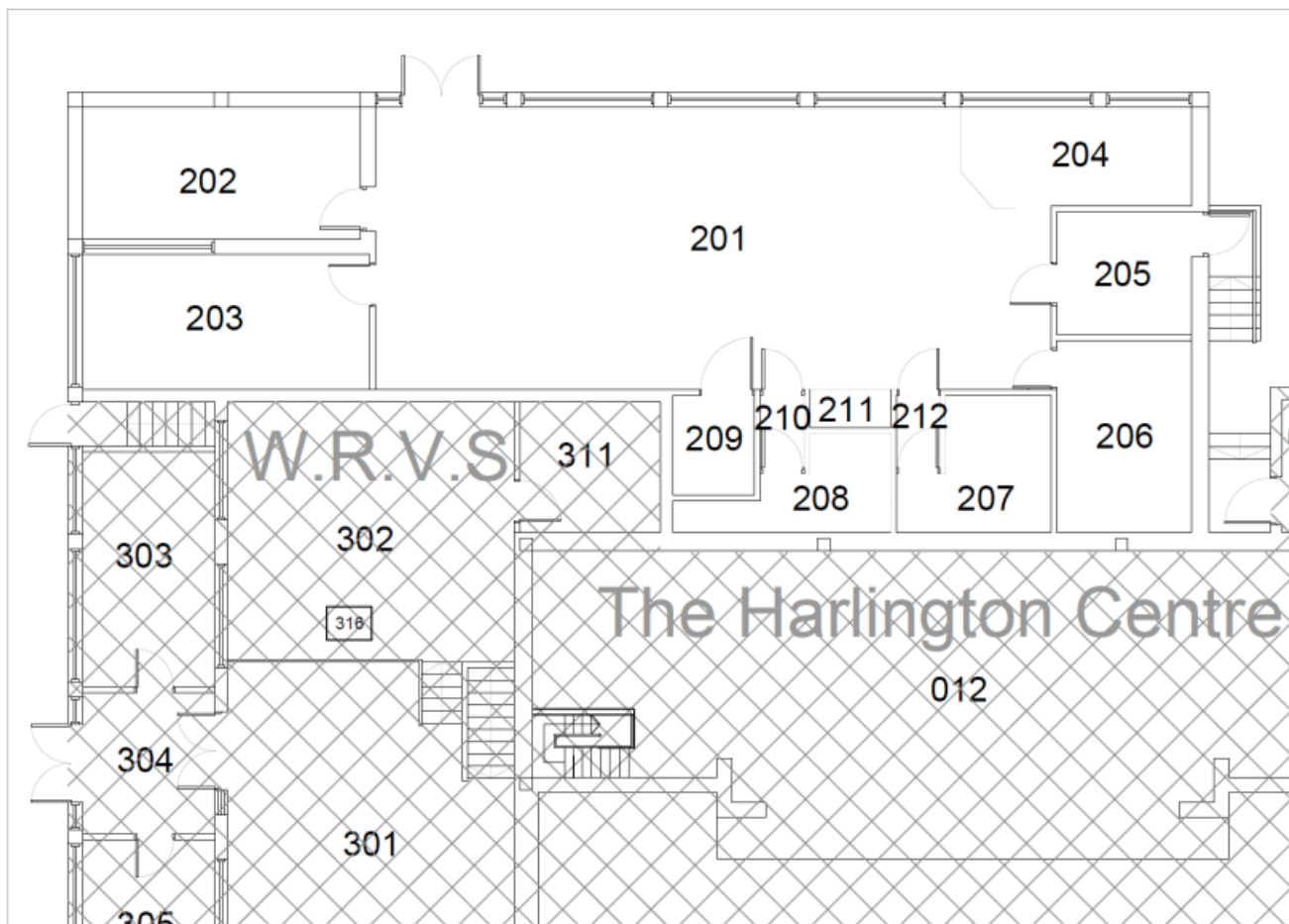



## THE POINT PLANS

No Asbestos Containing Material or material strongly presumed to contain asbestos was located during the survey of The Point.



Plan No. and Location	Product / Asbestos Type	Extent	Condition	Surface Treatment	Sampled / Presumed	Material Score <i>fiber release</i>	Priority Score <i>disturbance</i>	Risk Total	Action & Due Date	Action Comment	Other Comments
<b>1 - Backstage</b> corridor, both backstage changing rooms and stairs to basement HDC 033	BITUMEN floor tile adhesive & blue VINYL floor tiles	32m <sup>2</sup>	Minor damage - cracked top step and one missing tile under stage door	Sealed	Previous Sample	3	4	7	Monitor – material release very unlikely. No works carried out on these areas. Cover as temporary measure if required (tape).	Last Checked Aug 2025	-
<div>    </div> <div>BACKSTAGE FLOOR</div>											
<b>2 - Stage:</b> High level white boxed casing – top of wall HDC 012	High level casing INSULATING BOARD	16m <sup>2</sup>	Good	Painted	Strongly Presumed	9	4	13	Checked every August	Last Checked Aug 2025	-

Plan No. and Location	Product / Asbestos Type	Extent	Condition	Surface Treatment	Sampled / Presumed	Material Score <i>fiber release</i>	Priority Score <i>disturbance</i>	Risk Total	Action & Due Date	Action Comment	Other Comments
2 - Stage: Vertical panels to beam to stage opening HDC 012	Vertical panels to beam INSULATING BOARD	12m <sup>2</sup>	Minor damage - area of paint chipped away	Painted	Previous Sample	8	5	13	Damage now encapsulated	Last Checked Aug 2025	-





BEAM CASING





VERTICAL PANELS

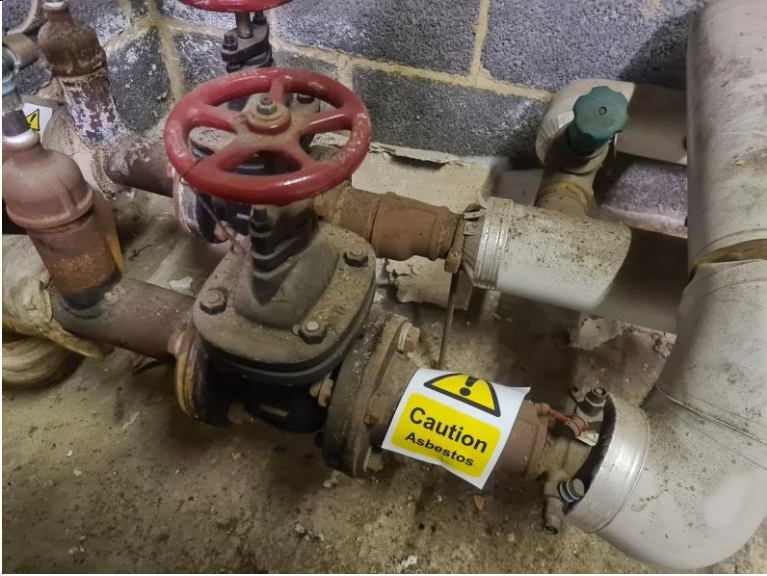

Plan No. and Location	Product / Asbestos Type	Extent	Condition	Surface Treatment	Sampled / Presumed	Material Score <i>fiber release</i>	Priority Score <i>disturbance</i>	Risk Total	Action & Due Date	Action Comment	Other Comments
3 - Main Kitchen stairs leading to 2 <sup>nd</sup> Floor HDC 020	BITUMEN floor tile adhesive & white VINYL floor tiles	10m <sup>2</sup>	Minor damage – some sections of tiles missing	Sealed	Previous Sample	2	4	6	Monitor – material release very unlikely. No works carried out on these areas. Cover as temporary measure if required (tape).	Last Checked Aug 2025	-
<div>  </div> <p>KITCHEN STAIRS – bottom (right) top (left)</p>											
4 – Loft: sealant around light fitting. The loft area accessed via the hatch above the General Managers Office	Light fitting sealant	-	Good	None	Previous Sample	4	4	8	Checked every August	Last Checked Aug 2025	-

Plan No. and Location	Product / Asbestos Type	Extent	Condition	Surface Treatment	Sampled / Presumed	Material Score <i>fiber release</i>	Priority Score <i>disturbance</i>	Risk Total	Action & Due Date	Action Comment	Other Comments
<div></div> <div>GM OFFICE LOFT HATCHFITTING</div>											
<b>5 - Plant Room</b> i.e. the main loft area, on right hand side of space once you reach top of access ladder. Accessed via ladder in storeroom behind dance studio. <b>HDC 075</b>	<b>GASKETS</b> compressed on pipe flanges	-	Good	None	Previous Sample	<b>2</b>	<b>2</b>	<b>4</b>	Checked every August	Last Checked Aug 2025	-



Plan No. and Location	Product / Asbestos Type	Extent	Condition	Surface Treatment	Sampled / Presumed	Material Score <i>fiber release</i>	Priority Score <i>disturbance</i>	Risk Total	Action & Due Date	Action Comment	Other Comments
<div><div>PLANT ROOM GASKET</div></div>											
6 – Basement above double doors leading into under stage via back stage corridor stairs HDC 069 + 073	Paneling above door frame  INSULATING BOARD	-	Minor damage – paint chipped	Painted	Previous Sample	7	4	11	Damage now encapsulated	Last Checked Aug 2025	-

Plan No. and Location	Product / Asbestos Type	Extent	Condition	Surface Treatment	Sampled / Presumed	Material Score <i>fiber release</i>	Priority Score <i>disturbance</i>	Risk Total	Action & Due Date	Action Comment	Other Comments
<div>   </div>											
<b>7 - Outside store</b> <b>i.e. 'market traders'</b> - as you walk into store, about halfway across back wall where wall meets ceiling <b>HDC 064</b>	Pipe Duct - Panel within pipe exit to ceiling - rear of area  <b>INSULATING BOARD</b>	-	Minor damage – wear to panel	None	Previous Sample	<b>8</b>	<b>3</b>	<b>11</b>	Damage now encapsulated	Last Checked Aug 2025	Add new photo when can view area around market equip

BASEMENT DOOR



Plan No. and Location	Product / Asbestos Type	Extent	Condition	Surface Treatment	Sampled / Presumed	Material Score <i>fiber release</i>	Priority Score <i>disturbance</i>	Risk Total	Action & Due Date	Action Comment	Other Comments
<div></div> <div>OUTSIDE STORE</div>											
8 - Roof void via right hand door in main loft accessed via ladder in store room behind dance studio. <b>HDC 076</b>	Roof felt – former roof including debris around penetration  BITUMEN	150m <sup>2</sup>	High risk – felt exposed and debris	None	Previous Sample	5	3	8	Checked every August	Last Checked Aug 2025	To enter voids a P3 respirator mask must be worn

Plan No. and Location	Product / Asbestos Type	Extent	Condition	Surface Treatment	Sampled / Presumed	Material Score <i>fiber release</i>	Priority Score <i>disturbance</i>	Risk Total	Action & Due Date	Action Comment	Other Comments
<div>   </div> <div>&lt; ROOF FELT IN VOID AREA 8</div> <div>&lt; FLOORING IN VOID AREA 8</div>											
<b>8 - Roof void via right hand door in main loft</b> accessed via ladder in store room behind dance studio. <b>HDC 076</b>	Floor - silver floor covering former roof  BITUMEN	150m <sup>2</sup>	Minor damage - age	None		3	3	6	Checked every August	Last Checked Aug 2025	To enter voids a P3 respirator mask must be worn
<b>8 - Roof void via right hand door in main loft</b> accessed via ladder in store room behind dance studio. Second void accessed through first void. <b>HDC 077</b>	Roof felt – former roof including debris around penetration  BITUMEN	220m <sup>2</sup>	High risk – felt exposed and debris	None	Previous Sample	5	3	8	Checked every August	Last Checked Aug 2025	To enter voids a P3 respirator mask must be worn

Plan No. and Location	Product / Asbestos Type	Extent	Condition	Surface Treatment	Sampled / Presumed	Material Score <i>fiber release</i>	Priority Score <i>disturbance</i>	Risk Total	Action & Due Date	Action Comment	Other Comments
<b>8 - Roof void via right hand door in main loft</b> accessed via ladder in store room behind dance studio. Second void accessed through first void. <b>HDC 077 &amp; 078</b>	Floor - silver floor covering former roof  BITUMEN	235m <sup>2</sup>	Minor damage - age	None	Previous Sample	3	3	6	Checked every August	Last Checked Aug 2025	To enter voids a P3 respirator mask must be worn
<b>9 - Function Room</b>	Windows – sealant to glazing PUTTY		Minor damage - age	None	Previous Sample	5	7	12	Checked every August	Last Checked Aug 2025	





FUNCTION ROOM WINDOWS



Plan No. and Location	Product / Asbestos Type	Extent	Condition	Surface Treatment	Sampled / Presumed	Material Score <i>fiber release</i>	Priority Score <i>disturbance</i>	Risk Total	Action & Due Date	Action Comment	Other Comments
10 - Duty Managers Office HDC 004	Under carpet/lino adhesive residues  BITUMEN	12m <sup>2</sup>	Minor damage – 1 tile lifted	Sealed	Strongly Presumed	5	6	11	Checked every August	Last Checked Aug 2025	-
 <p>DM OFFICE CARPET</p>											
11 - (what was) Café area HDC 003	Windows – sealant to glazing  PUTTY	-	Minor damage - age	None	Strongly Presumed	5	6	11	Checked every August	Last Checked Aug 2025	-







Plan No. and Location	Product / Asbestos Type	Extent	Condition	Surface Treatment	Sampled / Presumed	Material Score <i>fiber release</i>	Priority Score <i>disturbance</i>	Risk Total	Action & Due Date	Action Comment	Other Comments
13 - First floor landing HDC 047	Windows – sealant to glazing  PUTTY	-	Minor damage – age	None	Strongly Presumed	5	5	10	Checked every August	Last Checked Aug 2025	-
 <p>1<sup>ST</sup> FLOOR WINDOWS</p>											
14 - Basement boiler room HDC 063	Pipework – GASKETS compressed to pipework flanges	-	Minor damage - age	None	Strongly Presumed	5	4	9	Checked every August	Last Checked Aug 2025	-

Plan No. and Location	Product / Asbestos Type	Extent	Condition	Surface Treatment	Sampled / Presumed	Material Score <i>fiber release</i>	Priority Score <i>disturbance</i>	Risk Total	Action & Due Date	Action Comment	Other Comments
											
BOILER ROOM											
15 - Stairs off stage into basement HDC 071	Under stairs packing pieces in corner – adjacent top step.  INSULATING BOARD	-	Medium	None	Sampled	8	1	9	Checked every August	Last Checked Aug 2025	-
15 – stairs off stage into basement HDC 072	Inside boxing packing pieces- adjacent top step.  INSULATING BOARD	-	Medium	Painted	Sampled	8	1	9	Checked every August	Last Checked Aug 2025	-

Plan No. and Location	Product / Asbestos Type	Extent	Condition	Surface Treatment	Sampled / Presumed	Material Score <i>fiber release</i>	Priority Score <i>disturbance</i>	Risk Total	Action & Due Date	Action Comment	Other Comments
<div>   </div>											
16 - Fire exit off auditorium to RVS HDC 079	Under carpet/lino residues beneath non asbestos floor tiles  BITUMEN	20m <sup>2</sup>	Minor damage – few tiles missing	Sealed	Previous sample	3	3	6	Monitor – material release very unlikely. No works carried out on these areas. Cover as temporary measure if required (tape).	Last Checked Aug 2025	-



Plan No. and Location	Product / Asbestos Type	Extent	Condition	Surface Treatment	Sampled / Presumed	Material Score fiber release	Priority Score disturbance	Risk Total	Action & Due Date	Action Comment	Other Comments
<div><p>HALL TO RVS CORRIDOR FLOOR</p></div>											
17 - RVS Loft HDC 314	Floor - Former roof covering felt  BITUMEN	90m <sup>2</sup>	Medium – felt exposed	None	Presumed	4	4	8	Checked every August	Last Checked Aug 2025	To enter voids a P3 respirator mask must be worn





Plan No. and Location	Product / Asbestos Type	Extent	Condition	Surface Treatment	Sampled / Presumed	Material Score <i>fiber release</i>	Priority Score <i>disturbance</i>	Risk Total	Action & Due Date	Action Comment	Other Comments
EXTERNAL	Windows – sealant to glazing  PUTTY	1m <sup>2</sup>	Good	None	Strongly Presumed	5	2	7	Checked every August	Last Checked Aug 2025	-



EXTERNAL WINDOWS

**FULL ASBESTOS SURVEYS AVAILABLE BY CLICKING THE DOCUMENTS BELOW**

**Review full surveys before undertaking any DIY/contractual works**

<b>2024 SURVEY HARLINGTON</b>	 Harlington Asbestos Survey 202
<b>2024 SURVEY RVS</b>	 Asbestos Survey Report - WRVS - 14.
<b>2024 SURVEY THE POINT</b>	 Asbestos Survey The Point 2024.pdf
<b>2014 HISTORIC SURVEY HARLINGTON</b>	 Harlington Asbestos Survey 201
<b>Location on system:</b> Fleet Town Council\FTC - Documents\Health and Safety\6.Harlington\Asbestos\SURVEYS	
<b>ASBESTOS MANAGEMENT PLAN</b>	 New Asbestos Management Plan.d



# Material Risk Assessment Scoring Guide

## Product Type (or debris from product)

- 1 - Low risk: Asbestos-reinforced composites (plastics, resins, mastics, roofing felts, vinyl floor tiles, semi-rigid paints or decorative finishes, asbestos cement etc).
- 2 - Medium Risk: Asbestos insulating board, mill boards, other low density insulation boards, asbestos textiles, gaskets, ropes and woven textiles, asbestos paper and felt
- 3 - High Risk :Thermal insulation (eg pipe and boiler lagging), sprayed asbestos, loose asbestos, asbestos mattresses and packing

## Extent of Damage or Deterioration

- 0 - No risk: Good condition: no visible damage.
- 1 - Low Risk: Low damage: a few scratches or surface marks; broken edges on boards, tiles etc.
- 2 - Medium Risk: Medium damage: significant breakage of materials or several small areas where material has been damaged revealing loose asbestos fibres.
- 3 - High Risk: High damage or delamination of materials, sprays and thermal insulation. Visible asbestos debris.

## Surface Treatment

- 0 - No risk: Composite materials containing asbestos: reinforced plastics, resins, vinyl tiles.
- 1 - Low Risk: Enclosed sprays and lagging, AIB (with exposed face painted or encapsulated), asbestos cement sheets etc.
- 2 - Medium Risk: Unsealed AIB, or encapsulated lagging and sprays.
- 3 - High Risk: Unsealed lagging and sprays

## Asbestos Type

- 1 - Low risk: Chrysotile.
- Score 2 - Medium Risk: Amphibole asbestos excluding Crocidolite.
- Score 3 - High Risk: Crocidolite.

## **Scores for 4 sections above added together – then see total score against the below:**

- 10 or above; high potential to release fibres
- 7-9; Medium potential
- 5-6; Low potential
- 4 or below; Very Low potential

# Priority Risk Assessment Scoring Guide

## Occupant Activity – Main type of activity in area

0	Rare disturbance activity (e.g. little used store room)
1	Low disturbance activities (e.g. office type activity)
2	Periodic disturbance (e.g. industrial or vehicular activity which may contact ACMs)
3	High levels of disturbance (e.g. Fire door with AIB sheet in constant)

## Likelihood of Disturbance

**Score for 3 sections added together and divided by 3 for average score**

### Location

0	Outdoors
1	Large rooms or well-ventilated areas
2	Rooms up to 100m <sup>2</sup>
3	Confined spaces

### Accessibility

0	Usually inaccessible or unlikely to be disturbed
1	Occasionally likely to be disturbed
2	Easily disturbed
3	Routinely disturbed

### Extent / amount

0	Small amounts or items (e.g. strings, gaskets)
1	More than 10m <sup>2</sup> or 10m pipe run.
2	Between 10 and 50 m <sup>2</sup> or 10 and 50m pipe run.
3	More than 50m <sup>2</sup> or 50m pipe run.

## Human Exposure Potential

**Score for 3 sections added together and divided by 3 for average score**

### Number of occupants

0	None
1	1-3
2	4-10
3	More than 10

### Frequency of use of area

0	Infrequent
1	Monthly
2	Weekly
3	Daily

### Average time area in use

0	Less than 1 hour
1	Between 1 and 3 hours
2	Between 3 and 6 hours
3	More than 6 hours

## Maintenance Activity

**Score for 2 sections added together and divided by 2 for average score**

### Type of maintenance activity

0	Minor disturbance (e.g. possibility of contact when gaining access)
1	Low disturbance (e.g. changing light bulbs in AIB ceiling)
2	Medium disturbance (e.g. lifting one or two AIB ceiling tiles to access a valve)
3	High levels of disturbance (e.g. removing multiple AIB ceiling tiles for recabbling).

### Frequency of maintenance activity

0	ACM unlikely to be disturbed for maintenance
1	Less than or equal to 1 per year
2	More than 1 per year
3	More than 1 per month

**Scores/Average Score for 4 sections above added together – then see total score against the below:**

High	> 18	Urgent Action / Remove
Medium	14 - 17	Encapsulate / Seal & Monitor
Low	9 - 13	Monitor Six to Twelve Monthly
Minor	1 - 8	Monitor Annually